

PCE Concentration Contours
GW-1 Standard 5 ug/L

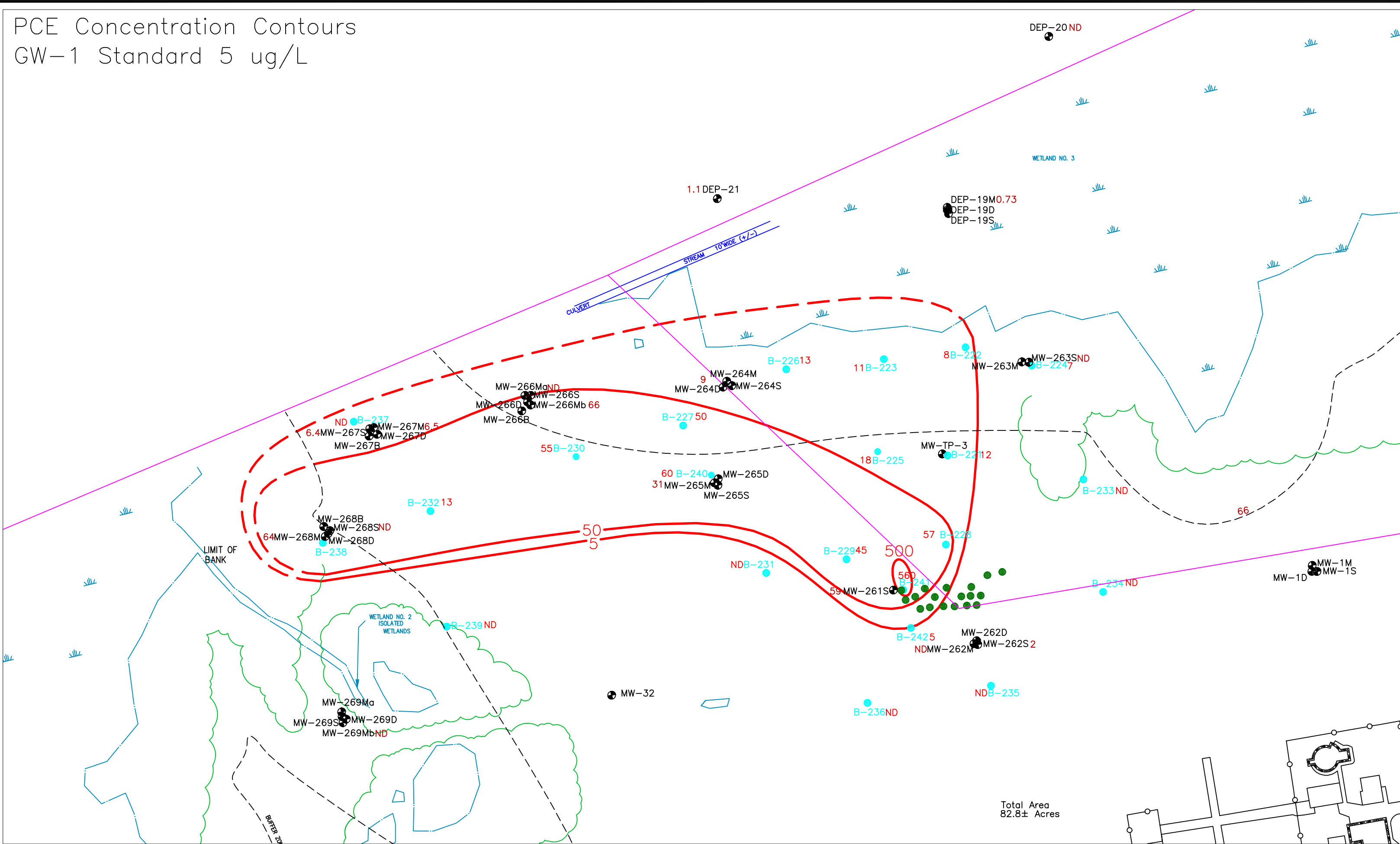

TCE Concentration Contours
GW-1 Standard 5 ug/L

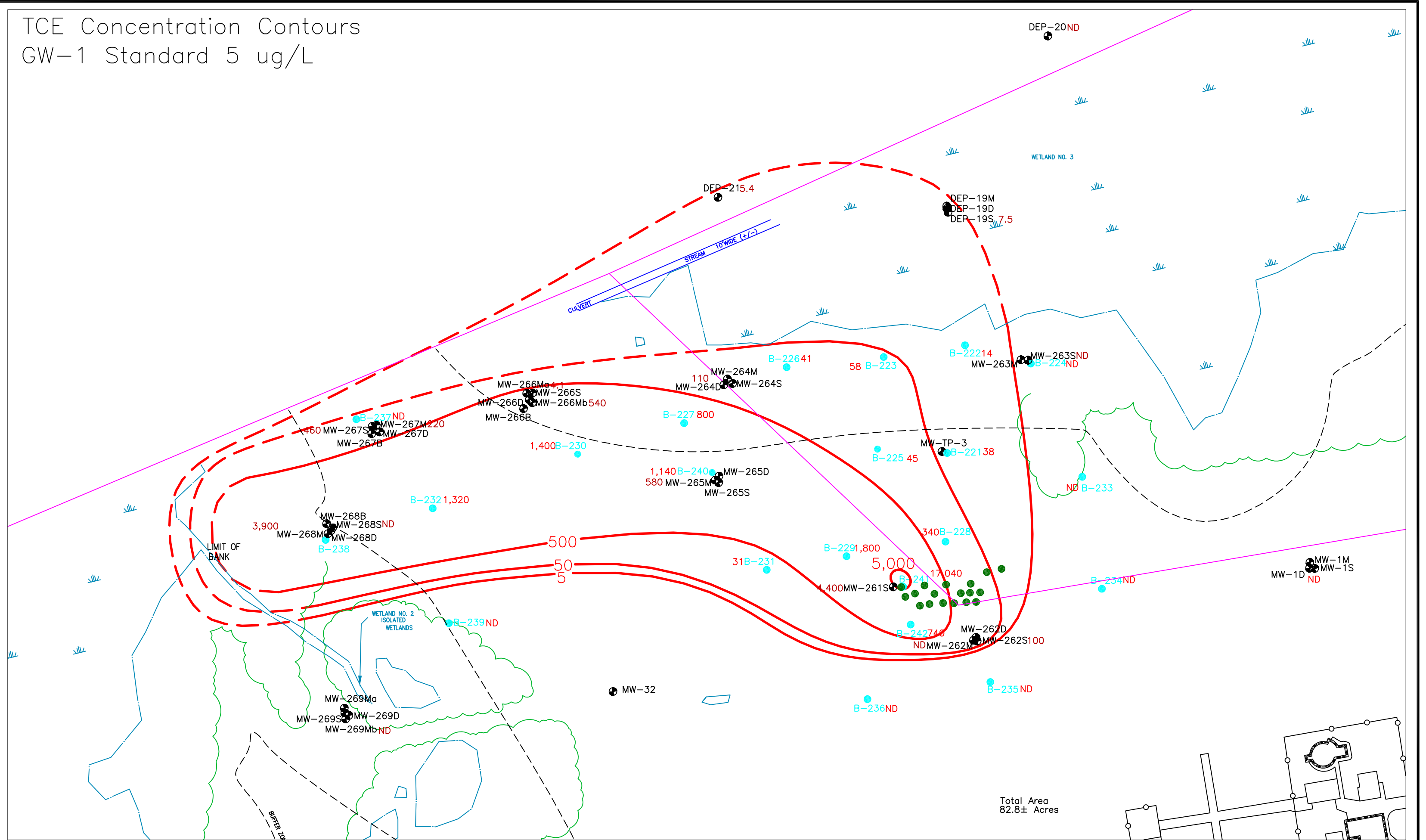

cDCE Concentration Contours
GW-1 Standard 70 ug/L

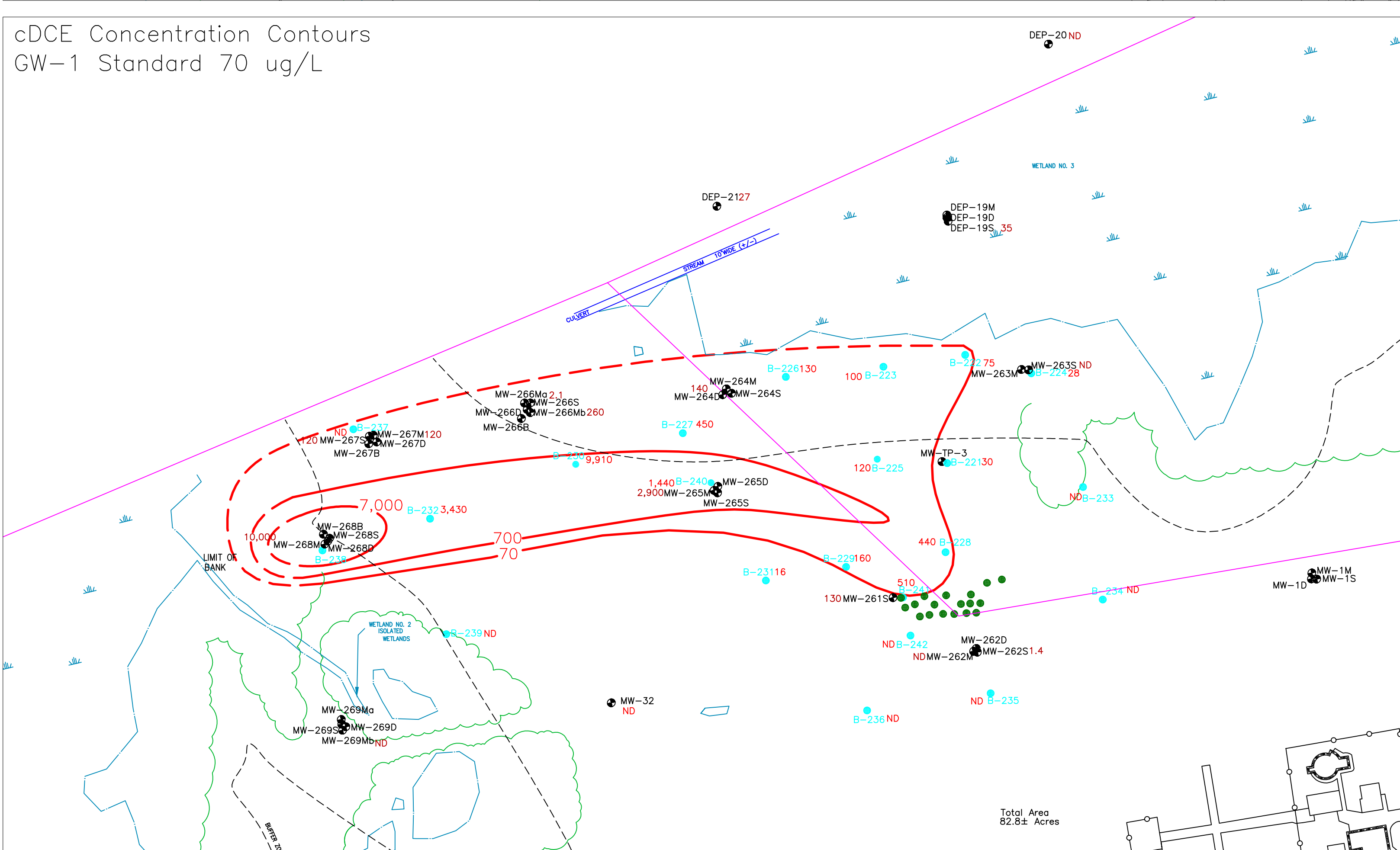

VC Concentration Contours
GW-1 Standard 2 ug/L

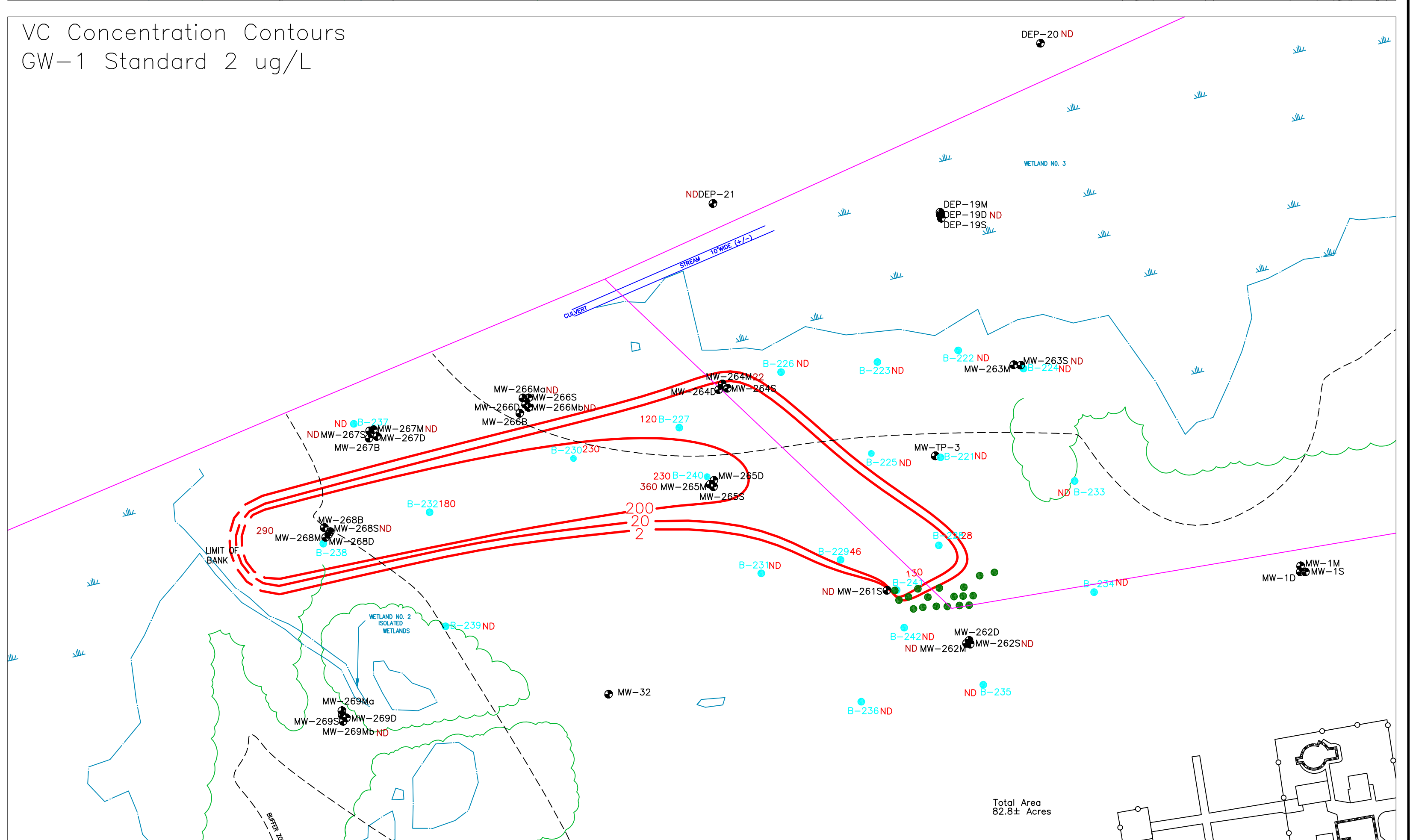

Legend

- 100' Buffer Zone
- Tree Line
- Delineated Wetland Boundary
- Property Line
- Concentrations (ug/L)
- Concentration Contour (ug/L) Dashed where Inferred
- Existing Monitoring Well Location
- Soil Boring Location
- Waterloo Profiler and/or CPT Boring Location

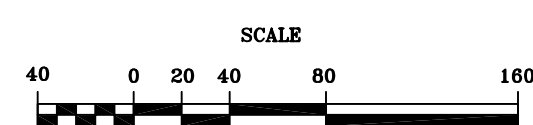

Notes:

Concentration contours presented based on the January 2003 groundwater sampling event and Waterloo Profiler field screening data from Summer 2002. Concentrations for DEP wells based on DEP July 2002 sampling data.

At locations where both monitoring well data and Waterloo Profiler data exist, the monitoring well data was used for contouring.

Concentrations labeled to the immediate right or left of well or boring ID.

Highest concentration at well clusters within fine sand and silt unit were used in plan view contours.



Environmental Resources Management
399 Boylston Street
Boston, MA 02116
(617) 267-8377

Revisions			
Symbol	Description	Date	Approved
	Northern Wetlands Deep with Waterloo		
	R:\Raytheon\Wayland - 1922\Raytheon - State Plane.dwg		

Designed by:
Drawn by: JE
Checked by: JP
Reviewed by: RJF
Submitted by:

Former Raytheon Facility
430 Boston Post Road Wayland, MA
Plan View of CVOC Concentration Contours
Scale: 1"=80'
Date: 4/17/03
Drawing No. Figure No. 7
Contract No. 1922.03